

- Notes:
1. Do not scale from drawing
  2. All dimensions in metres unless otherwise stated

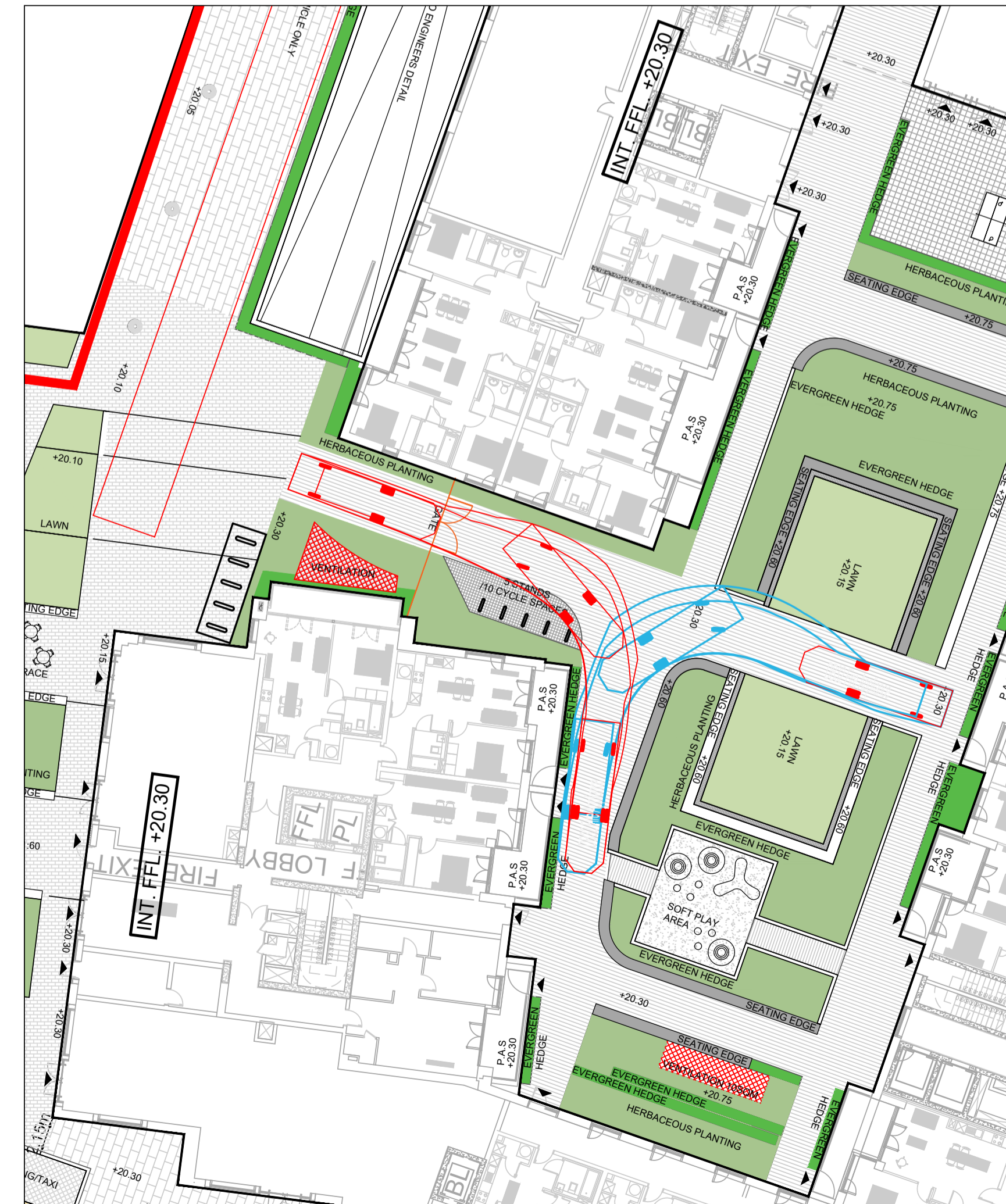

Rev	Date	Revision made	Drawn	Checked	Approved
C	09/11/2020	UPDATED LAYOUTS	AMP	AM	AA
B	14/09/2020	UPDATED TO DCC COMMENTS	AMP	AM	AA
A	27/03/2020	FIRST ISSUE	AMP	AM	AA

© This drawing is the property of SYSTRA Limited and the information can only be reproduced with their prior permission.

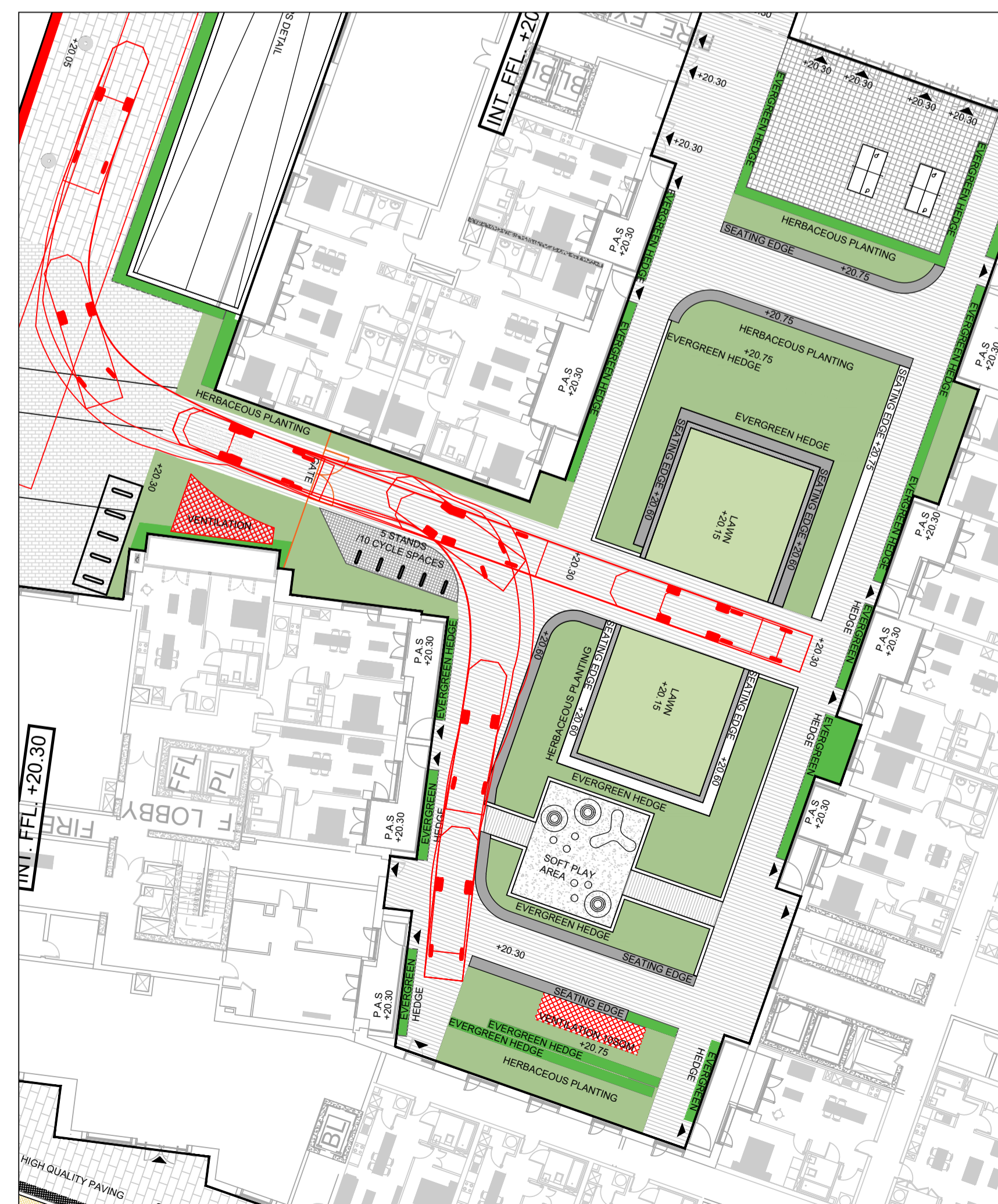
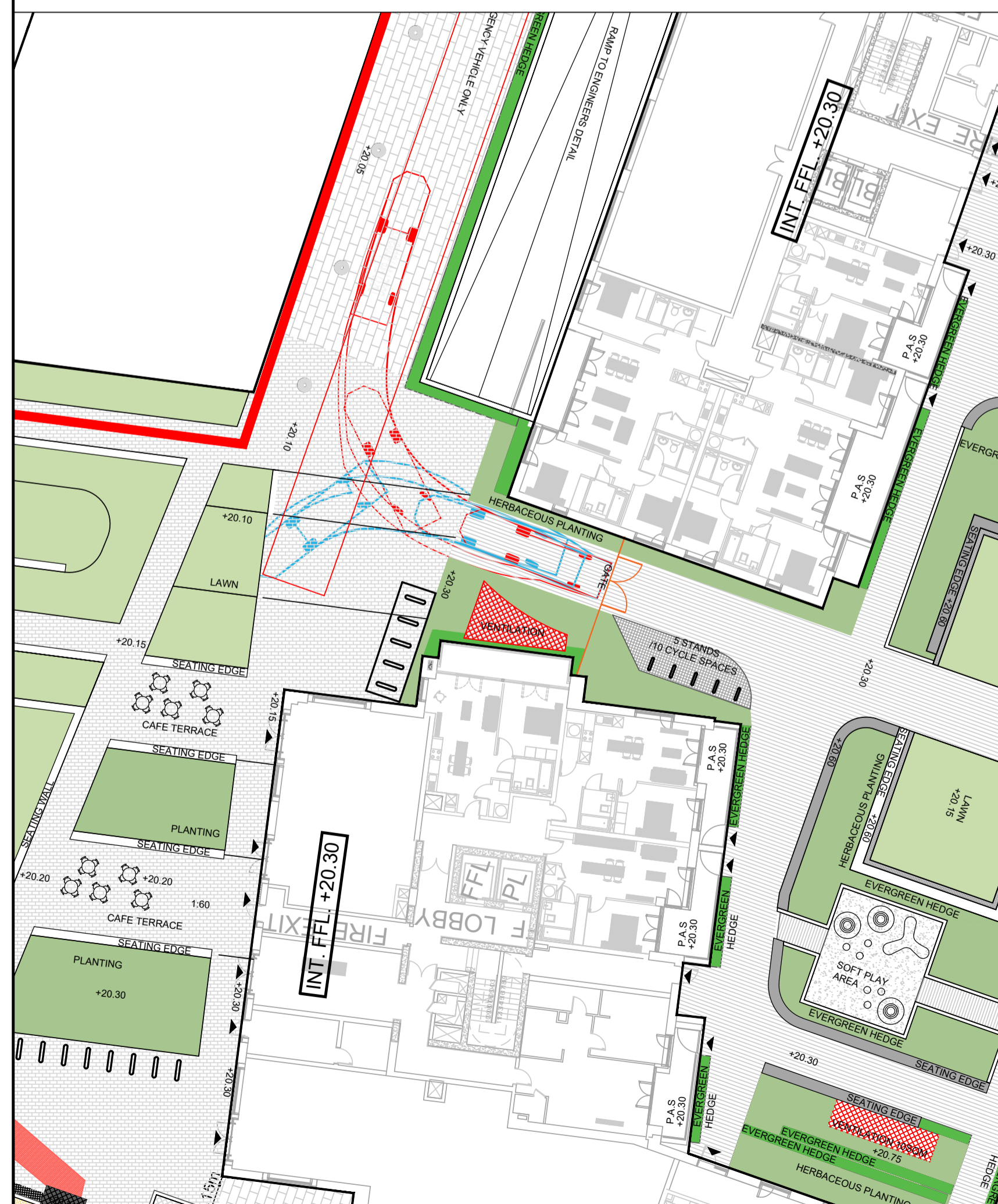
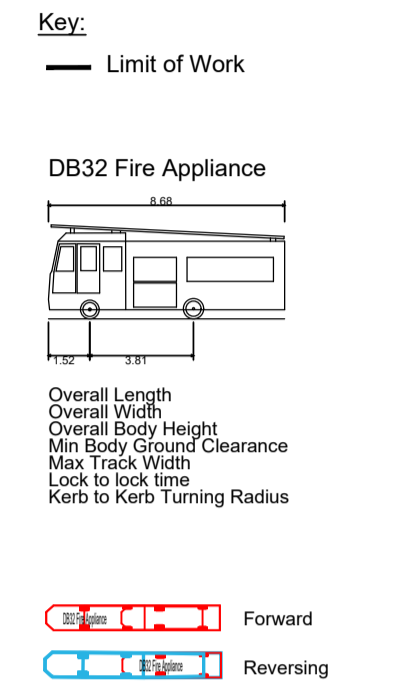

2nd Floor, Riverview House  
 21-23 City Quay, Dublin 2  
 D02 FP21 Tel: +353 1 566 2028

Client: DBTR-SCR1 Fund,  
 a Sub-Fund of the CWTC Multi Family ICAV

Project: Proposed Strategic Housing Development on the  
 former Player Wills site and undeveloped land  
 owned by Dublin City Council,  
 at South Circular Road, Dublin 8.

Title: VEHICLE TRACKING  
 FIRE TENDER  
 Sheet 2 of 2

Drawn	Checked	Approved
AMP	AM	AA
Original drawing size	Date	Scale
A1	December 2020	1:250
Drawing Status	Drawing Number	Rev.
FINAL	SYS-PW-04.2	C